

**DISASSEMBLY & ASSEMBLY SWING CHECK VALVE**  
3" - 4" 1500-2500 LBS.

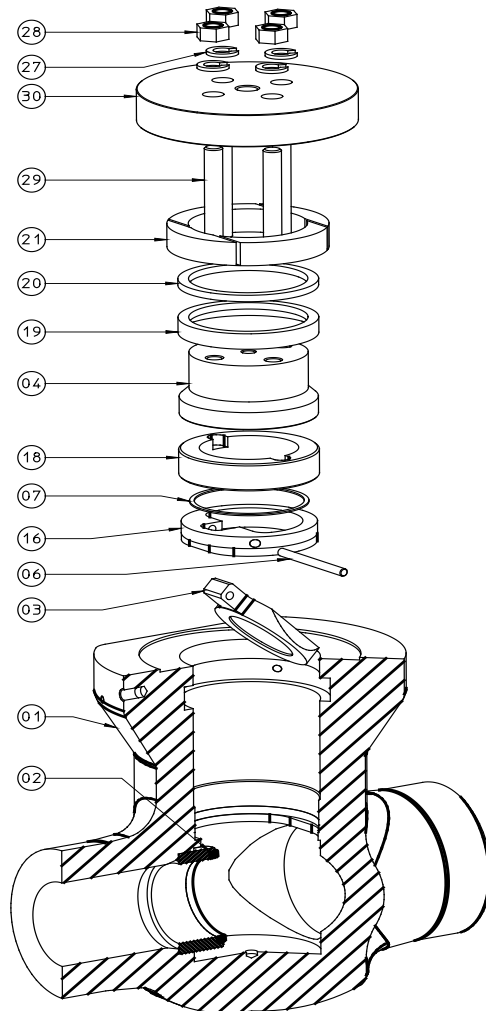

1. Caution, before any attempt is made to disassemble, verify that the valve is isolated from system pressure and secured against accidental pressurisation.
2. Unscrew the nuts (28) on top of the bonnet plate (30) and remove the spring washers (27) and the bonnet plate.
3. Push down the bonnet (04) and remove the segmental ring (21) out of the valve body (01), by pressing the pins through the bore holes. Now remove the ring (20) and the gasket (19), together with the bonnet.
4. Unscrew the lock ring (18) out of the valve body and remove the gasket (07) and the disc (03) / holder (16) assembly.
5. Remove the disc out of the disc holder by pressing out the disc pin (06).

INSPECTION FOR RE-ASSEMBLY

1. Thoroughly wipe all parts with solvent and a clean cloth.
2. Examine the following parts for pitting or scratches:
  - A. SEAT (02) - Sealing surface
  - B. DISC - Sealing surface
  - C. BONNET - Sealing surface
3. Place the disc into the disc holder and secure it by the disc-pin. Now place this assembly into the valve body with the flat machined face to the flat machined face of the valve body.
4. Place the gasket and secure this assembly with the lock ring.
5. Spray the new gasket with molykote K321 R, or equivalent and place it over the bonnet, now place ring.
6. Lower this assembly carefully into the valve body. Place the segmental ring in the valve body. Make sure that there is no split between two segments in front of a disassembly hole.
7. Screw the bonnet bolting (29) into the bonnet and place the bonnet plate. Place the spring washers and screw on the nuts and tighten them.
8. Pressurise the system and check the bonnet.

IMPORTANT

After starting up the system, once the valve has reached its working temperature and pressure, it is recommended to tighten the nuts of the bonnet-plate to force the bonnet into the gasket for optimum sealing.

9. In case of leaking of the bonnet tighten the nuts.
10. The valve is now ready for use.