

DISASSEMBLY & ASSEMBLY GLOBE VALVE
WITH FLOATING BACKSEAT $\leq 2\frac{1}{2}$ "

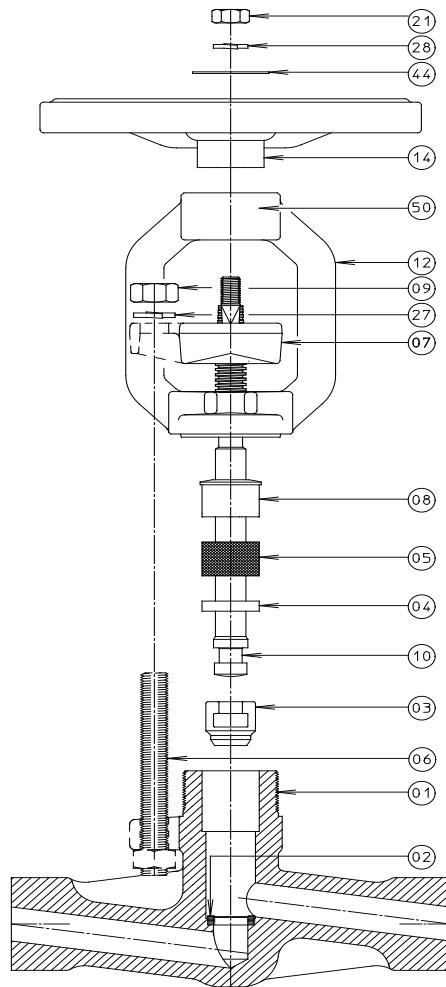

1. Caution, before any attempt is made to disassemble, verify that the valve is isolated from system pressure and secured against accidental pressurisation.
2. Unscrew the nuts (09) from the gland bolts (06) and remove the gland bolts.
3. Open the valve completely.
4. Loosen the yoke by applying a force in a counterclockwise direction and unscrew it partly from the body (01) :
 - 7 revolutions for 3/8" - 1/2" valves
 - 10 revolutions for 3/4" - 1" valves
 - 17 revolutions for 1 1/4" - 2" valves
5. Turn the hand wheel (14) counterclockwise, past the fully open position to force the packing (05) and the floating backseat (04) out of the stuffing box.
6. Unscrew the yoke and jack it together with the remaining parts out of the valve body.
7. Remove the nut (21) which secures the hand wheel and rotate the hand wheel clockwise to unscrew the stem (10) from the yoke sleeve (50) until the hand wheel disengages from the stem.
8. Continue unscrewing the stem by gripping it below the yoke (12)
9. Remove the gland flange (07), the gland (08), the packing and the floating backseat from the stem by holding the stem vertically on a bench with the threaded end down and pressing down the floating backseat.

INSPECTION FOR RE-ASSEMBLY

1. Thoroughly wipe all parts with solvent and a clean cloth.
2. Examine the following parts for pitting or scratches:
 - A. SEAT (02) - Sealing surface
 - B. STEM - Packing area
 - C. DISC (03) - Sealing surface
3. Grease all threaded parts with molykote HCS, or equivalent.
4. Insert the stem/disc assembly into the valve body.
5. Insert the floating backseat (with radius down) into the valve body.
6. Insert the packing into the valve body (with markings down).
7. Place the gland over the stem.
8. Put the yoke together with the gland flange over the stem.
9. Screw the yoke on the valve body, while turning the stem counterclockwise.
10. Fix the gland flange with the stud bolts.
11. Fix the hand wheel and nameplate (44) to the stem with the nut and washer (28).
12. Tighten the nuts of the stud bolts (to compress the packing).
13. Loosen the nuts of the stud bolts.
14. Then carefully tighten the nuts of the stud bolts again.
15. Pressurise the system and check the gland packing.
16. In case of leaking, tighten the nuts of the gland bolts carefully until the leaking stops.